



Smart Freeway Mitchell Southbound: Hester Avenue to Warwick Road

Update for the Liwara Primary School community

The Smart Freeway Mitchell Southbound: Hester Avenue to Warwick Road project includes the construction of an additional 8.7 km freeway lane and a dedicated lane from Hepburn Avenue entry ramp to Warwick Road exit ramp, 7.6 km of shared paths, 5.5 km of noise walls and the installation of Smart Freeway Technology on nine southbound freeway entry ramps.

Night works for traffic realignment – Mitchell Freeway southbound between Hepburn Avenue and Warwick Road

Monday 18 July – Friday 22 July 2022, approximately 9:00pm – 4:00am

We would like to advise the school community that on four evenings between Monday 18 July – Friday 22 July 2022 between approximately 9:00pm – 4:00am, works will occur to relocate the temporary roadside barrier from the median to the verge side of the freeway to accommodate upcoming widening works on the verge. The freeway (southbound) will be closed between Hepburn Avenue and Warwick Road, with a detour in place (detour map overleaf).

This work will involve removal of redundant line marking and barriers, and replacement with new line marking and barriers. Freeway traffic will be progressively shifted to the three far right lanes.

This work is required to occur at night, when traffic flow is minimal, for the safety of workers and road users and to avoid disruption to daytime traffic flows.

Commencement of freeway widening works on verge side - Mitchell Freeway southbound between Hepburn Avenue and Warwick Road – from late July 2022

Once the barriers are in place from the above night works, the removal of vegetation along the freeway verge, including adjacent to the school, will commence. The clearing is expected to take approximately two weeks. This will make space for construction of a new traffic lane adjacent to

the verge to facilitate safer merging, a new emergency stopping lane and modifications to the entry ramps at Hepburn Avenue and Warwick Road.

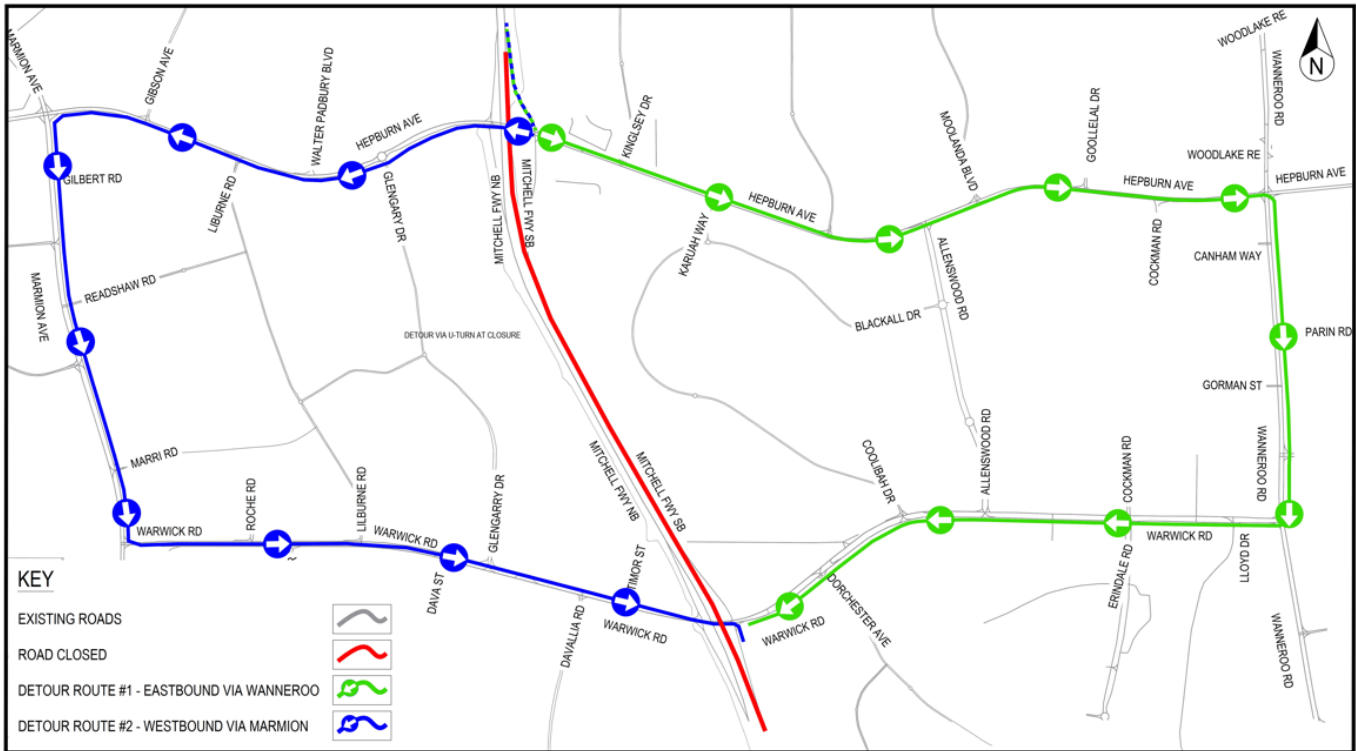

Motorist detour in place from 18 – 22 July (9pm – 4am) between Warwick Road and Hepburn Avenue

Further information

We have a 24/7 project information line that can be contacted on 138 138 or email enquiries@mainroads.wa.gov.au

To stay up to date with the project, subscribe to email notifications via our project webpage at: www.mainroads.wa.gov.au/smart-freeways